

PLAN
Scale 1"=40'

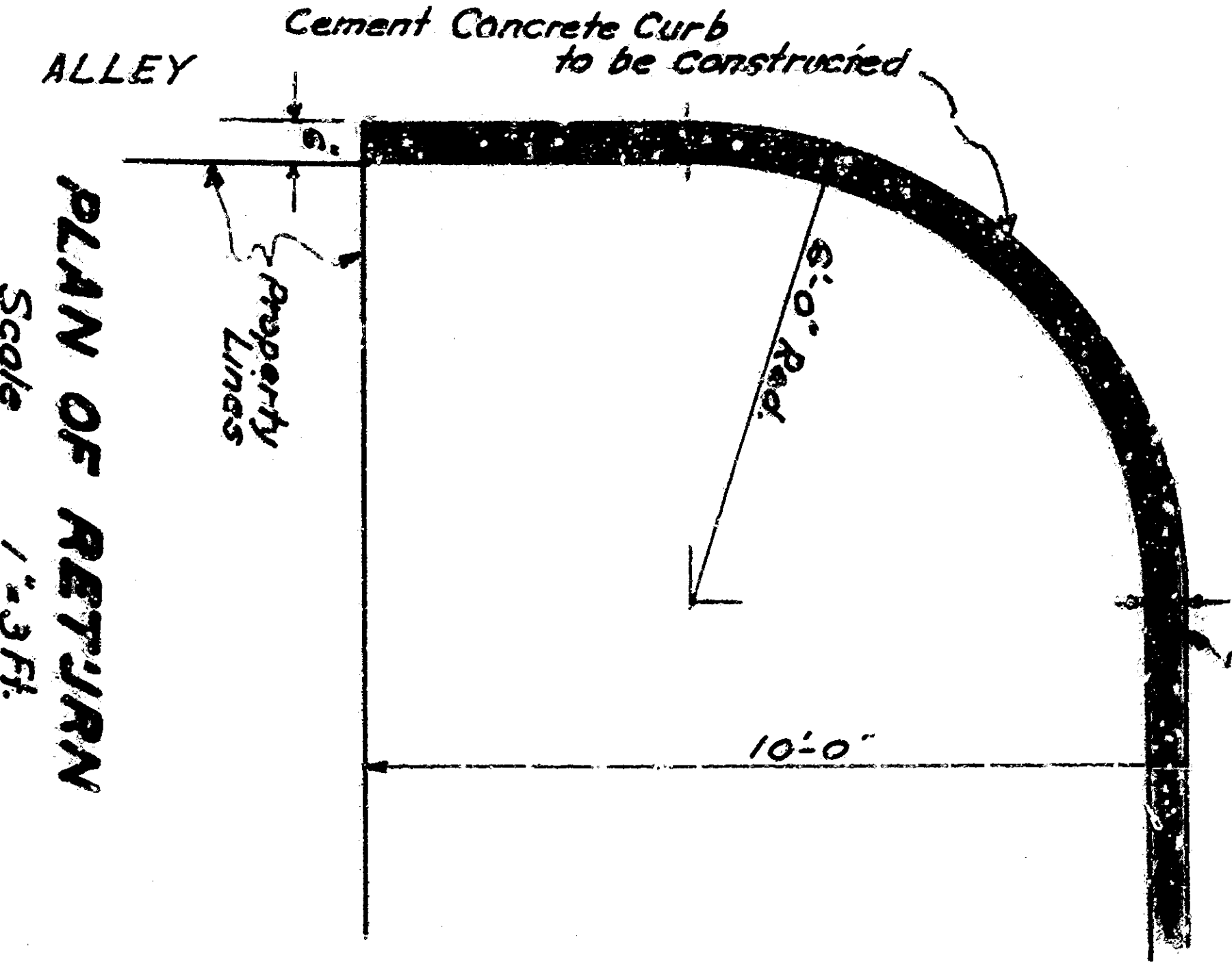

MT. VERNON AVENUE

AVENUE

PLAN NO. 1745
FOR THE
IMPROVEMENT OF
SIXTEENTH STREET,
BETWEEN MT. VERNON AVE. AND WESTERN AVE.
CITY OF SAN BERNARDINO
CALIFORNIA.

NOV. 1947
R. P. FORSYTHE
Acting City Engineer

PLAN ADOPTED November 3, 1947

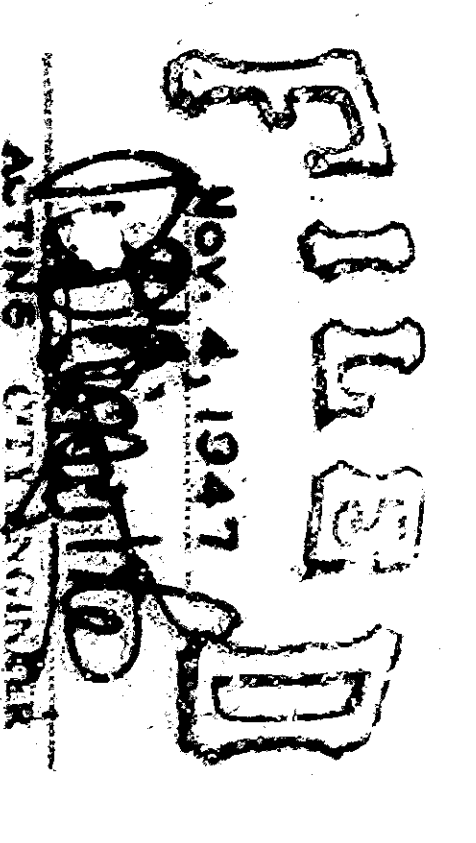

LEGEND:
 1/2" in. means inch or inches.
 10' Ft. means foot or feet.
 M.S. means Masonry Street.
 A.V. means Avenue.
 E.I. means elevation.
 C.C. means Concrete Curb to be constructed.
 S.S. means shown in other plans.
 C.C. shown in plan thus... in section thus...
 S.S. shown in plan thus... in section thus...

EXPANSION JOINTS:
 Expansion joints to be constructed at 50 foot intervals.

GRADE RESOLUTION:
 Grade of Sixteenth St. established by Resolution No. 105 Dated May 18, 1931.

TITLE TO STREET:
 Title to Sixteenth Street is held by the City of San Bernardino.

DATUM:
 All elevations shown in feet and inches are based on a datum of 1170 feet above sea level.

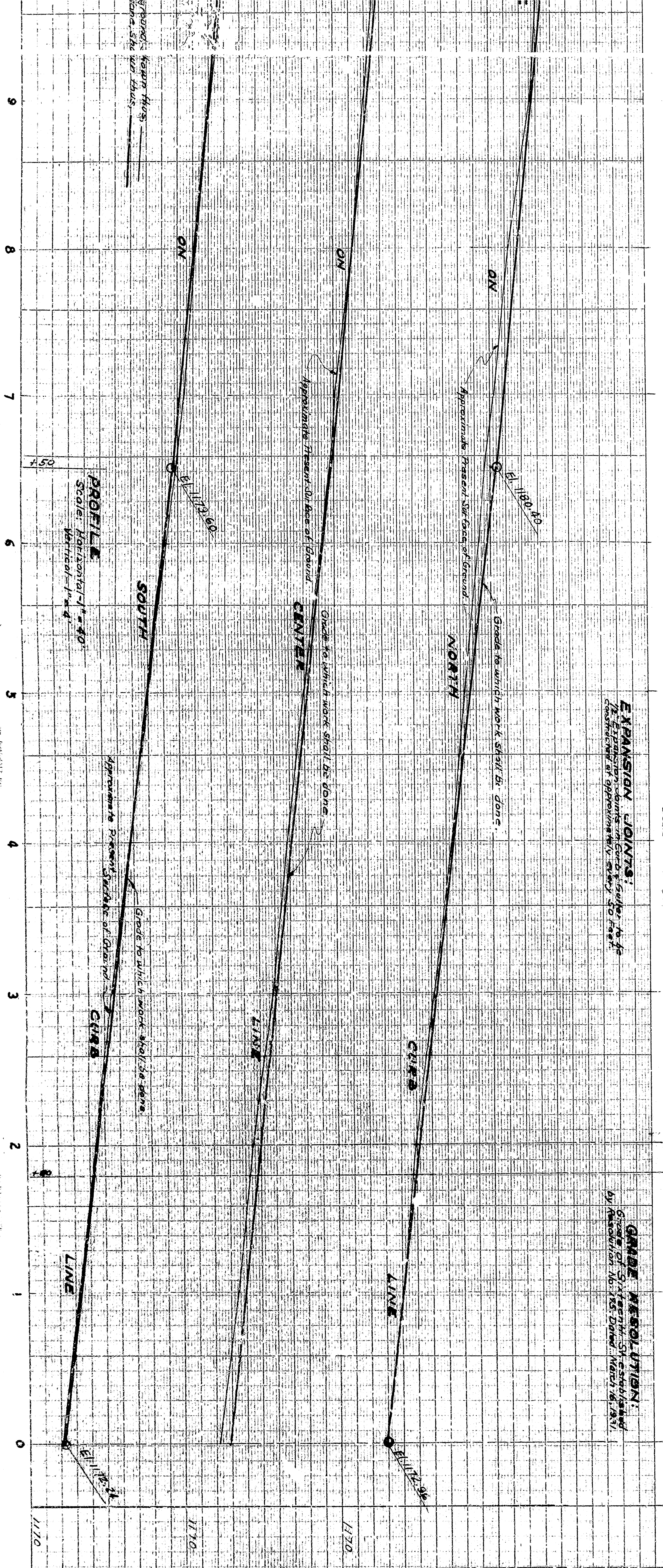

PROFILE
Scale: Horizontal 1"=40'
Vertical 1"=4'

1170
1170
1170